

### PLANTA BAJA VIVIENDA

Sup. construida = 95.82 m<sup>2</sup>  
 Sup. útil = 81.14 m<sup>2</sup>

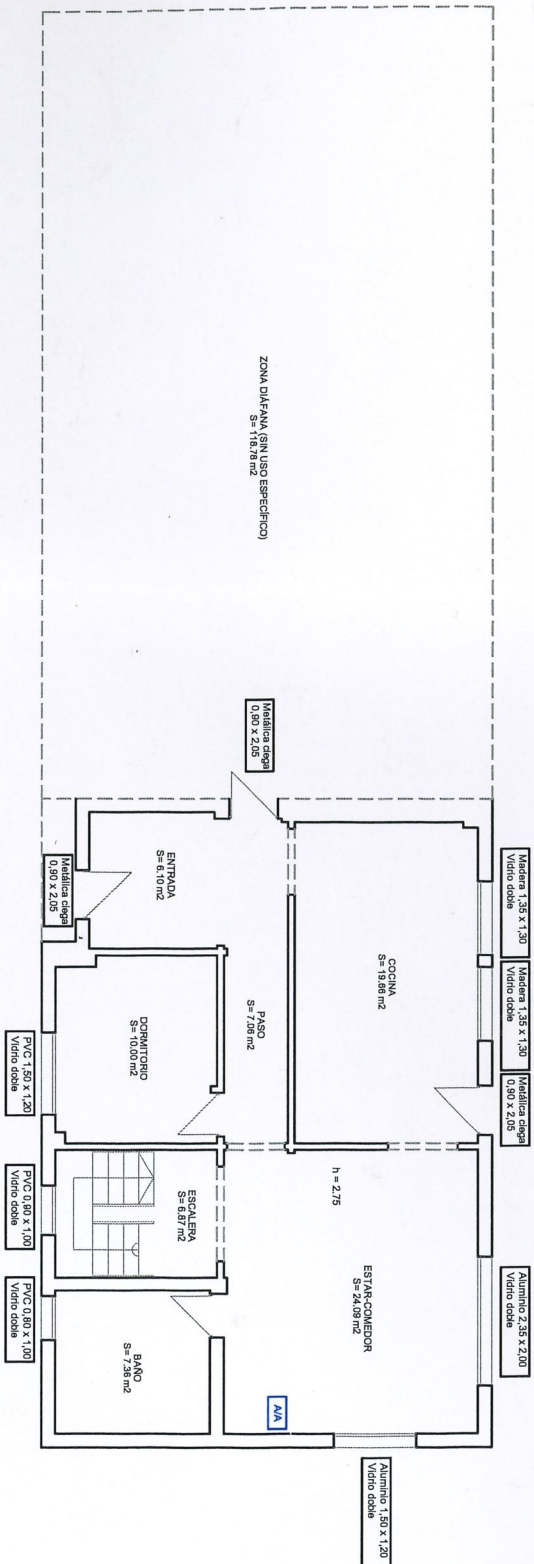

### TOTALES EDIFICACION

Sup. construida p.baja = 214.60 m<sup>2</sup>  
 Sup. construida p.pliso = 214.60 m<sup>2</sup>

### PLANTA PISO VIVIENDA

Sup. construida = 94.25 m<sup>2</sup>  
 Sup. útil = 79.59 m<sup>2</sup>

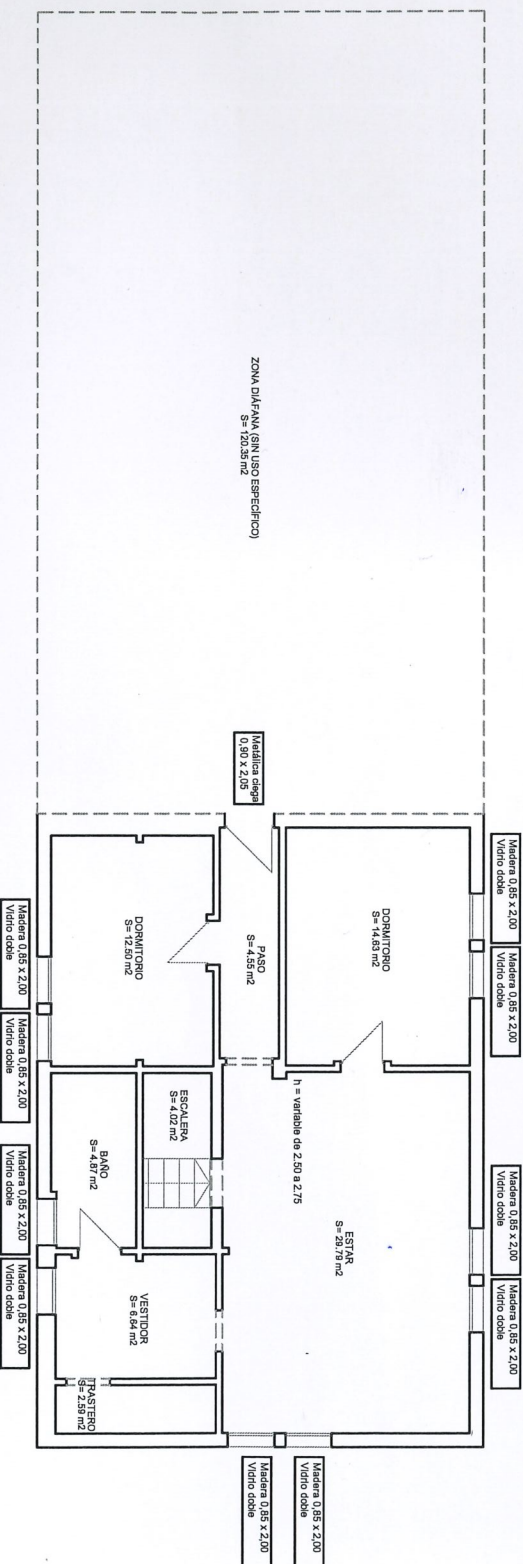

### TOTALES VIVIENDA

Sup. construida = 190.07 m<sup>2</sup>  
 Sup. útil = 160.73 m<sup>2</sup>